

Maintenance

15 daily

Check the dispenser and make sure there are not product leaks from the tap assembly seal. If you notice a leak, check first and foremost that the components have been assembled correctly, then make sure the seal is not worn or faulty, in which case replace it with an original spare part from the manufacturer.



16 weekly

WARNING !

Check for the presence of any leakage by removing the purpose-designed tray. In case they are present, make sure the scraper coupling seal is properly installed and not worn. If it is, replace with an original spare part from the manufacturer.

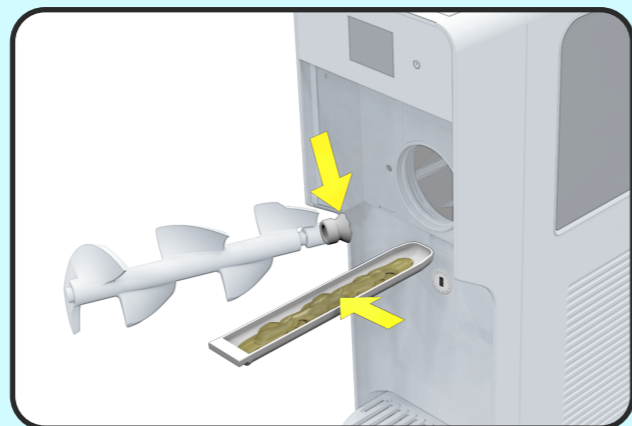

At each washing, ensure seal piston valve.

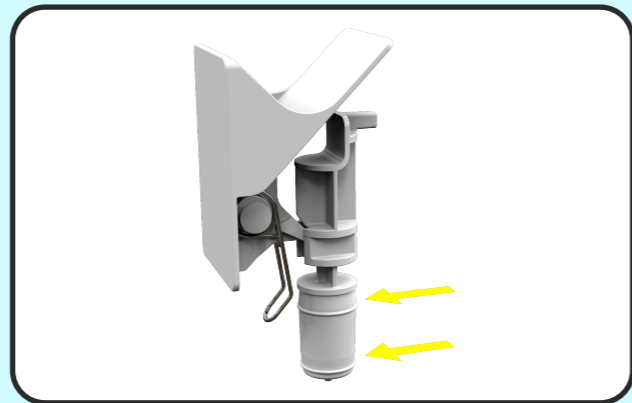

17 monthly

Eliminate any dust that has built up on the condenser filter situated at the rear of the machine.



codice 02114-00100 / rev. 5-22L18

Installation

- 1 Position the dispenser on a bench capable of supporting the weight, even at full load.

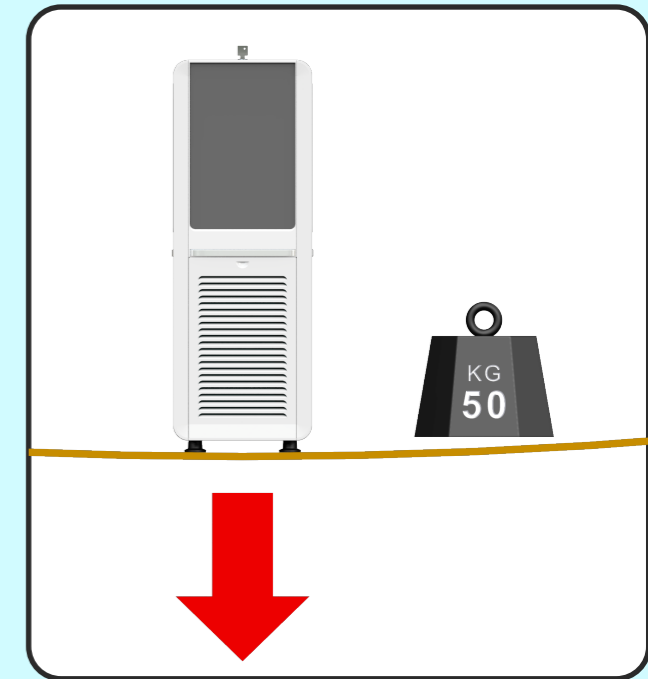

- 2 Allow a minimum clearance of at least 15 cm all around the dispenser so as not to impede the flow of cooling air.

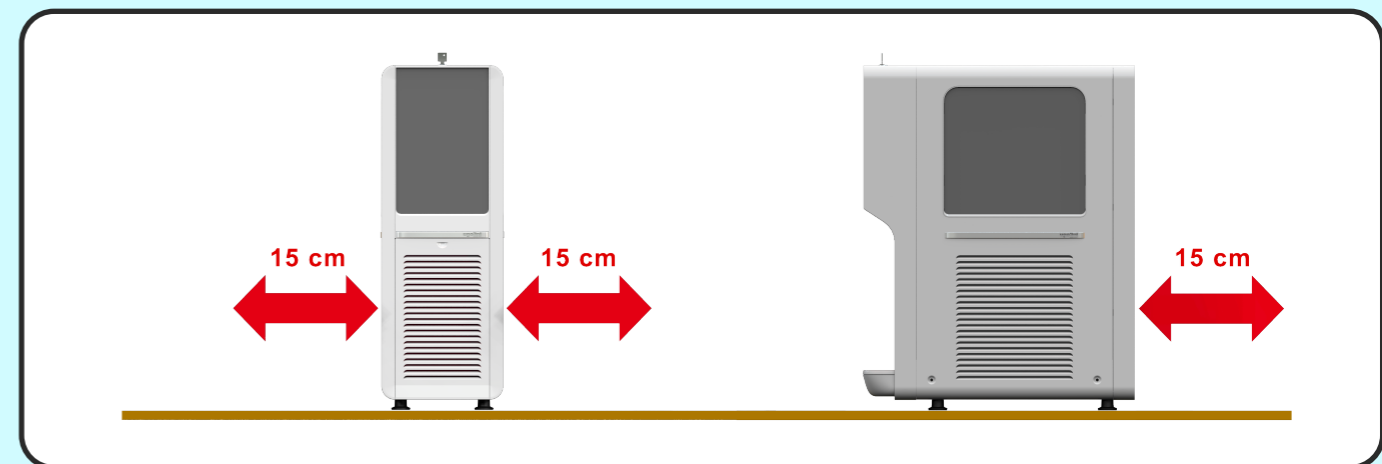

- 3 Connect the dispenser to a single phase network, using an outlet complete with earthing. Do not use extension cables.

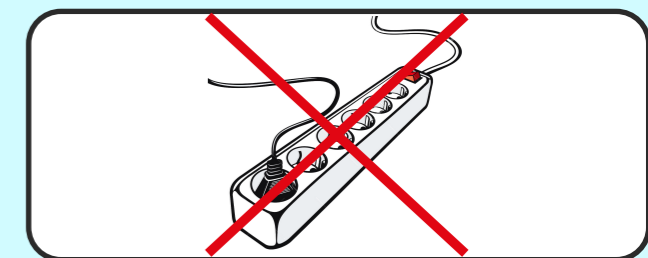

Operating procedures

4 Clean and sanitize the unit.

5 Prepare approximately 5 liters of mix following manufacturer's instructions.

6 Open the upper cover. Turn the upper part of the mixing pipe completely anti-clockwise.

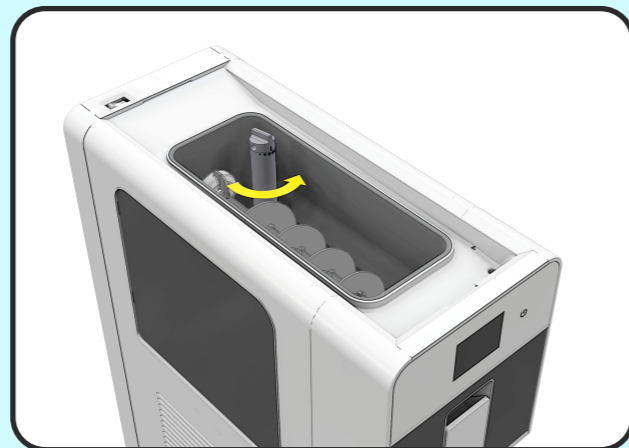

7 Pour the mixture into the upper tank and wait for the cylinder to fill up. This will occur when no more air bubbles exit the hole in the mixing pipe.



WARNING !

For correct operation of the device not suitable for the tank without the presence of the tube.

8 Turn the upper part of the mixing pipe completely clockwise in order to stop the mixture entering the cylinder. Close the upper cover.

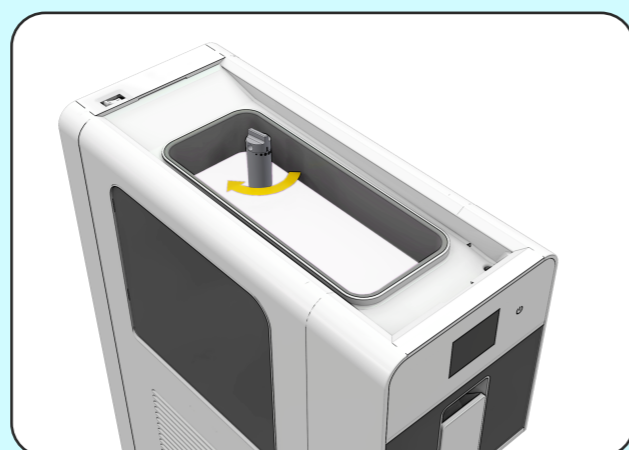

9 Turn the machine ON using the main switch situated on the top distributor in the backside part.

To start the unit keep pressed key A. Select ice-cream mode pressing icon B. Use the key 'C' to set the required ice cream density. We suggest to start from low values and then increase the density progressively.

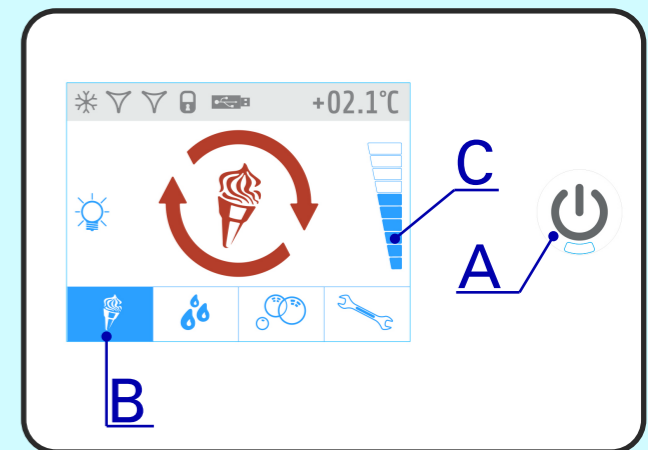

10 Machine will stop automatically when ice-cream is ready.

11 Open the cover and turn the upper part of the mixing pipe anti-clockwise to allow the mixture to enter the lower cylinder. The quantity of air in the ice cream can be adjusted, keeping in mind that, starting from the closing position:

- minimum rotation corresponds to a softer ice-cream.
- complete rotation corresponds to a more compact ice-cream.

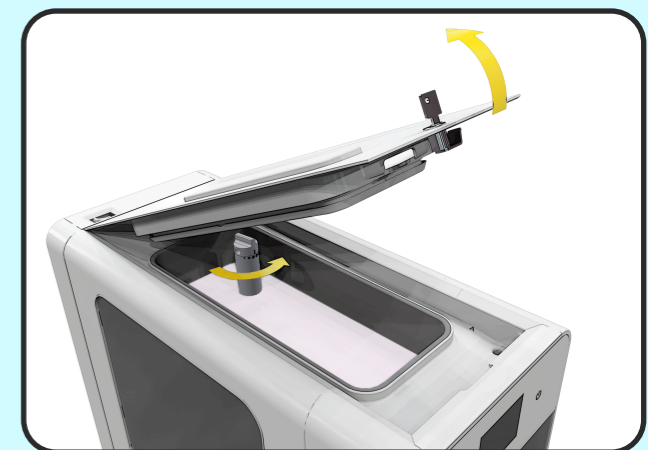

12 Close the cover and let the dispenser operate continuously.

13 Dispense the ice cream using the faucet handle.



14 In case the density setting range wouldn't be enough to obtain the required result, the mix can be modified as follows:
Ice cream too soft : increase the quantity of liquid (water or milk) from 5 % to 10 % of the total volume
Ice cream too hard (oppure too compact) : decrease the quantity of liquid (water or milk) from 5 % to 10 % of the total volume.